



SHARK Force 3

Ergonomic Gaming Mouse

Manual

Specifications

General:

■ Max. DPI/CPI:	12,800
■ Min. DPI/CPI:	400
■ Sensor:	Optical
■ Chip:	A825
■ Illumination:	RGB
■ Max. Polling Rate:	1,000 Hz
■ Lift-Off Distance:	1–2 mm
■ Frames Per Second:	7,000
■ Inches Per Second:	60
■ Max. Acceleration:	20 g
■ Mouse Feet:	5, 100 % PTFE
■ Color Versions:	Black
■ Weight without Cable:	100 g
■ Dimensions (L x W x H):	130 x 80 x 41 mm
■ Supported Operating Systems:	Windows

Button Properties:

■ Number of Buttons:	8
■ Main Button Switches:	Huano
■ Operating Life Cycles of Buttons:	Min. 3 Million Clicks

DPI Properties:

■ DPI Levels:	400; 800; 1,600; 3,200; 6,400; 12,800
■ DPI Switch:	✓
■ DPI Indicator:	LED

Cable and Connectors:

■ Connector:	USB
■ Gold-Plated USB Plug:	✓
■ Textile-Braided Cable:	✓
■ Cable Length:	180 cm

Package Contents:

■ SHARK Force 3, Additional Set of Mouse Feet

Overview

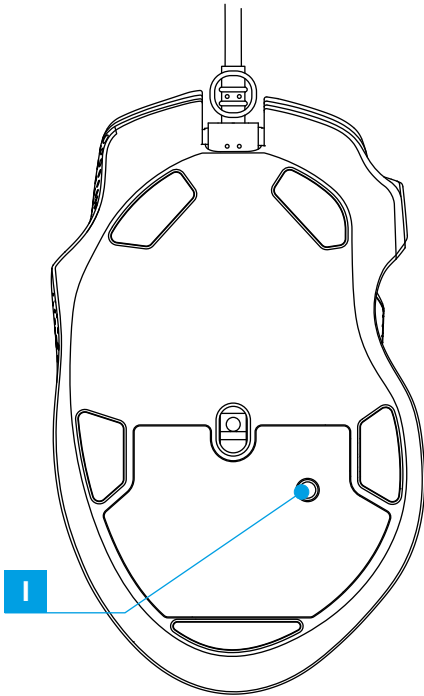
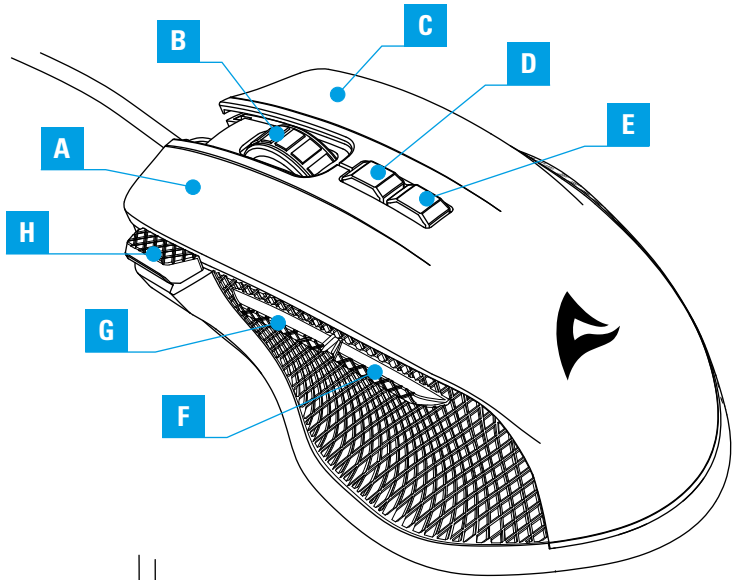

- A** Left Mouse Button
- B** Scroll Wheel
- C** Right Mouse Button
- D** DPI +
- E** DPI -
- F** Thumb Button 2
- G** Thumb Button 1
- H** Rapid Fire
- I** RGB Switch

Connecting the Gaming Mouse

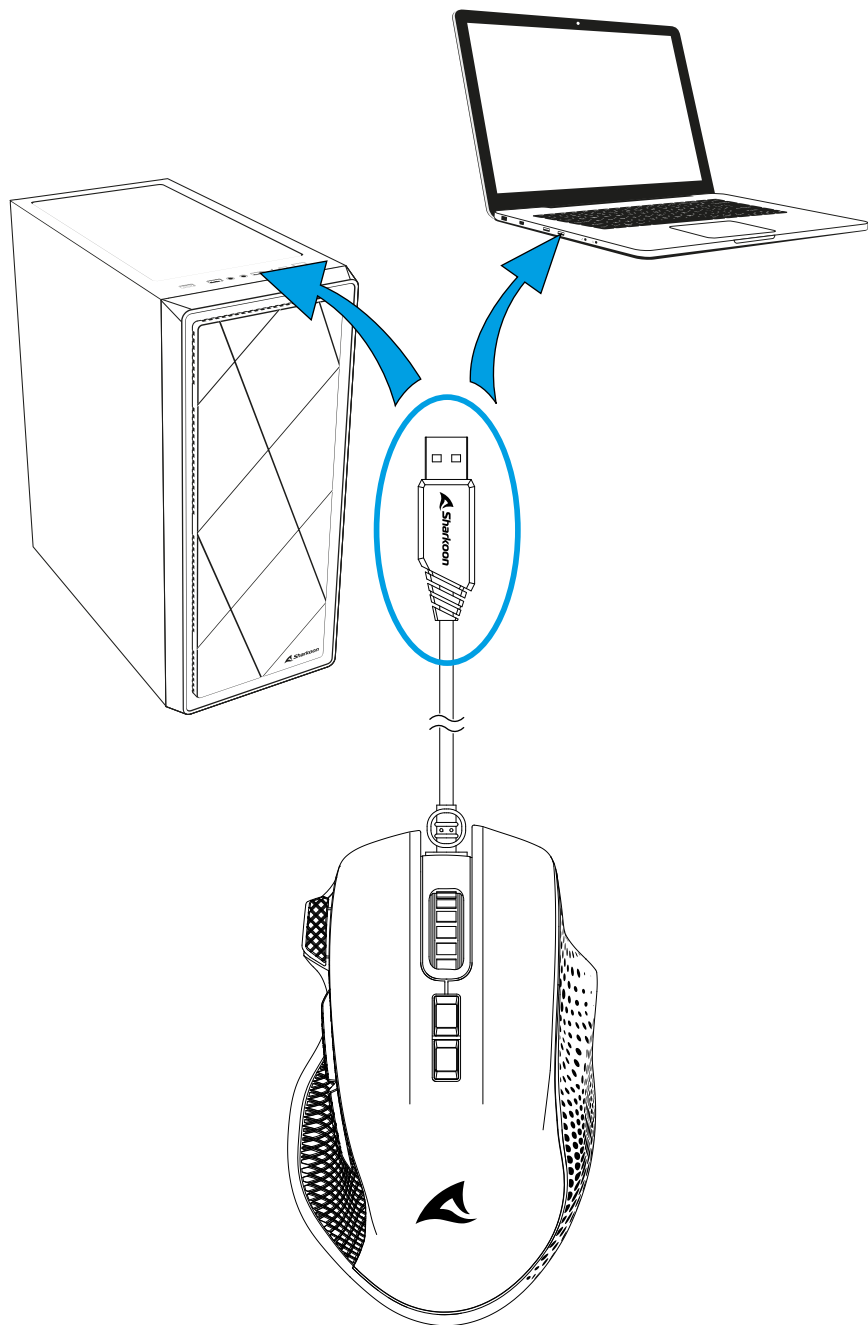

Legal Disclaimer

For potential loss of data, especially due to inappropriate handling, Sharkoon assumes no liability.

All named products and descriptions are trademarks and/or registered trademarks of the respective manufacturers and are accepted as protected. As a continuing policy of product improvement at Sharkoon, the design and specifications are subject to change without prior notice. National product specifications may vary.

All rights reserved especially (also in extracts) for translation, reprinting, reproduction by copying or other technical means. Infringements will lead to compensation. All rights reserved especially in case of assignation of patent or utility patent. Means of delivery and technical modifications reserved.

Disposal of your old products

Your product is designed and manufactured with high quality materials and components, which can be recycled and reused.



When this crossed-out wheeled bin symbol is attached to a product, it means the product is covered by the European Directive 2012/19/EU.

Please be informed about the local separate collection system for electrical and electronic products. Please act according to your local rules and do not dispose of your old products with your normal household waste. The correct disposal of your old product will help prevent potential negative consequences to the environment and human health.

Follow us on social media!



Facebook



Instagram



YouTube



TikTok



X

Sharkoon Technologies GmbH

Grüninger Weg 48

35415 Pohlheim

Germany

© Sharkoon Technologies 2024



R39507
RoHS

